

Motor VeGA Y196VE 2021
model VeGA 545 SXHE 7in1

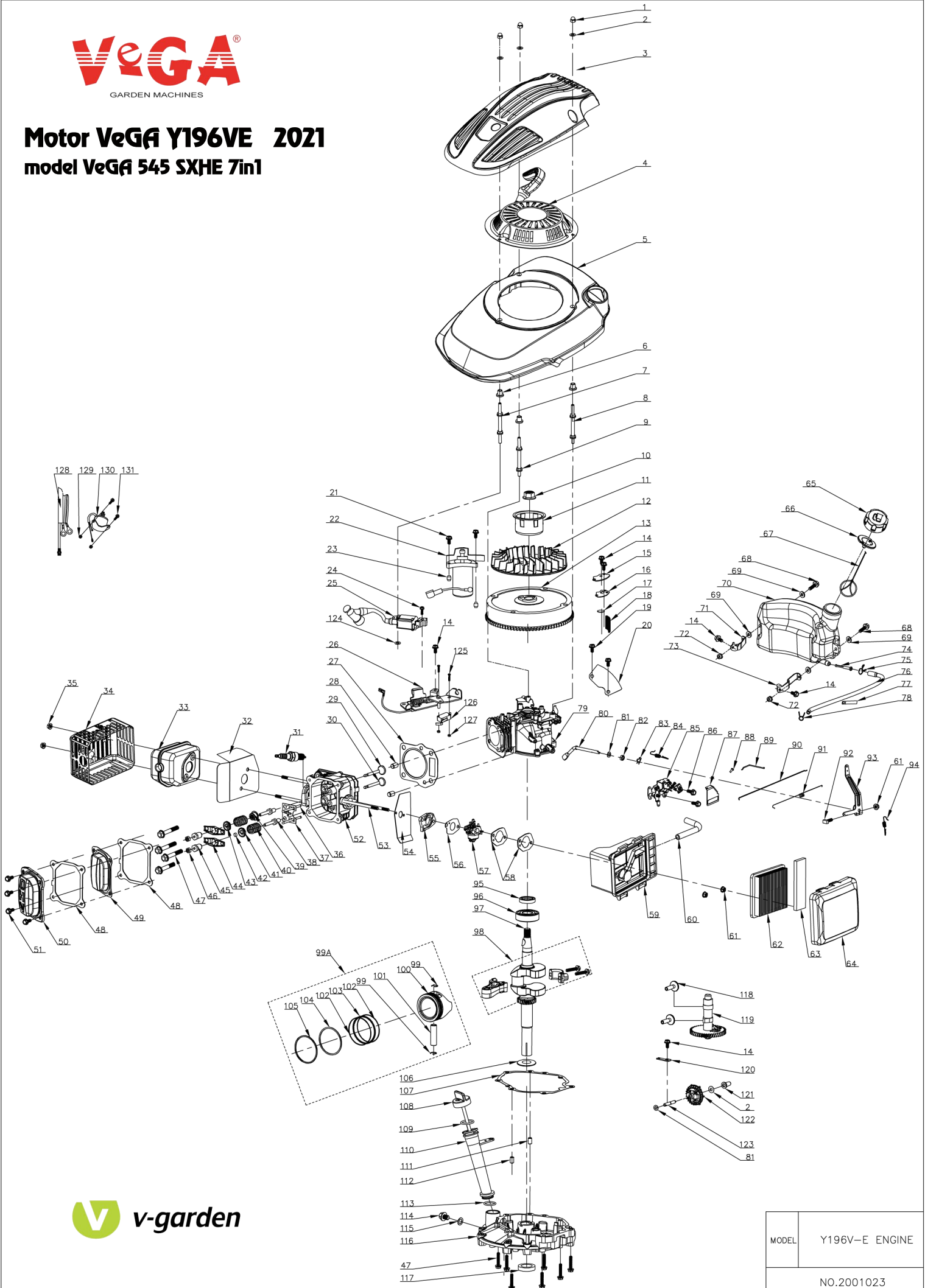

| | |
|------------|----------------|
| MODEL | Y196V-E ENGINE |
| NO.2001023 | |

| No. | ID zboží | Název |
|-----|-------------|---------------------------|
| 1 | B2002B00000 | Nut |
| 2 | B5027B00000 | Washer |
| 3 | Y3A11000013 | Engine Cover |
| 4 | Y2A20000000 | Recoil Start |
| 5 | Y3A3NA00010 | Blower Housing |
| 6 | Y2A40000000 | Blush |
| 7 | Y3AB0000000 | Bolt I |
| 8 | Y3A80000000 | Bolt II |
| 9 | Y3A90000000 | Bolt III |
| 10 | B2015W00000 | Nut |
| 11 | Y3A50000000 | Start-up Hub |
| 12 | Y3A60000000 | Fan |
| 13 | Y3B12000000 | Flywheel |
| 14 | B1058W06012 | Bolt |
| 15 | Y3250000000 | Plate |
| 16 | Y3240000000 | Gasket Respirator Cover |
| 17 | Y3230000000 | Valve Element |
| 18 | Y2220000000 | Lubricate Filtering Net |
| 19 | B1057W06010 | Bolt |
| 20 | Y3AA1000000 | Plate |
| 21 | B1067W06035 | Bolt |
| 22 | Y3B40000000 | Starting Motor |
| 23 | Y3B80000000 | Pin |
| 24 | B1064W06025 | Bolt |
| 25 | Y2B20000000 | Ignition |
| 26 | Y37N0000000 | Brake Assy |
| 27 | Y3120000000 | Gasket of Cylinder Cover |
| 28 | Y2260000000 | Locating Pin |
| 29 | Y3520000000 | Inlet valve |
| 30 | Y3530000000 | Outlet valve |
| 31 | Y2B30000000 | Spark Plug |
| 32 | Y2930000000 | Gasket of Muffler |
| 33 | Y3910000000 | Muffler Assy |
| 34 | Y3920000000 | Muffler Cover Assy |
| 35 | B2016W00000 | Nut |
| 36 | Y55C0000000 | Handspike |
| 37 | Y35E0000000 | Handspike Assy |
| 38 | Y2580000000 | Rocker Bolt of Valve |
| 39 | BC011H00000 | Oil Seal |
| 40 | Y3540000000 | Spring of Valve |
| 41 | Y2560000000 | Spring Coil outlet Valve |
| 42 | Y25D0000000 | upper cap of outlet Valve |
| 43 | Y2550000000 | Spring Coil outlet Valve |
| 44 | Y2570000000 | Rocker of Valve |
| 45 | Y2590000000 | Adjust Nut of Valve |
| 46 | Y25A0000000 | Combined Nut |
| 47 | B1080W08050 | Bolt |
| 48 | Y2130000000 | Gasket of Cylinder Cover |

| No. | ID zboží | Název |
|-----|-------------|---------------------------|
| 49 | Y3140000000 | Cyl. Head Inner Cover |
| 50 | Y3150000000 | Cyl. Head Outer Cover |
| 51 | B1059W06014 | Bolt |
| 52 | Y3110000000 | Cylinder Head Assy |
| 53 | B4002W06092 | Bolt |
| 54 | Y3810000000 | Paper Gasket Inlet Pipe |
| 55 | Y3820000000 | Air Inlet Pipe |
| 56 | Y3830000000 | Paper Gasket Carburetor |
| 57 | Y585B000000 | Carburetor |
| 58 | Y2840000000 | Paper Gasket Air Filter |
| 59 | Y2870000100 | Air Filter Pedestal |
| 60 | Y38A0000000 | Exhaust Pipe |
| 61 | B2012W00000 | Nut |
| 62 | Y3880000000 | Paper Filter Element |
| 63 | Y28C0000000 | Filter Element |
| 64 | Y2860000000 | Air Filter Upper Cover |
| 65 | Y28H0000000 | Fuel Tank Cap |
| 66 | Y28F0000000 | Seal Gasket Tank Cap |
| 67 | Y28T0000000 | Connecting Rope |
| 68 | B1063W06022 | Bolt |
| 69 | Y28S0000000 | Gasket |
| 70 | Y28D0000000 | Fuel Tank |
| 71 | Y38N0000000 | Right Bracket Fuel Tank |
| 72 | B2008W00000 | Nut |
| 73 | Y38M0000000 | Left Bracket of Fuel Tank |
| 74 | Y28E0000000 | Fuel filter tube |
| 75 | Y28K0000000 | Ring |
| 76 | Y38J0000000 | Oil Pipe |
| 77 | Y28U0000000 | Oil Pipe Fixing Clip |
| 78 | Y28L0000000 | Ring |
| 79 | Y5210000000 | Crankcase |
| 80 | Y3660000000 | Speed Regulator Spindle |
| 81 | B5026W00000 | Flat Washer |
| 82 | BC006B00000 | Oil Seal |
| 83 | Y2670000000 | Springness Split Pin |
| 84 | Y36A0000600 | Speed Regulator Spring |
| 85 | Y2690000500 | Speed Regulator |
| 86 | B1072W06008 | Bolt |
| 87 | Y2690000504 | Plate |
| 88 | B300CW00000 | Screw |
| 89 | Y56D0000000 | Handspike of Valve |
| 90 | Y56B0000000 | Handspike of Valve |
| 91 | Y36C0000000 | Spring of Valve |
| 92 | B1085W06023 | Bolt |
| 93 | Y3680000100 | Speed Regulator Rocker |
| 94 | Y36A0000700 | Speed Regulator Spring |
| 95 | BC004B00000 | Oil Seal |
| 96 | B0008W00000 | Ball Bearing |

| No. | ID zboží | Název |
|---------|-------------|------------------------------------|
| 97 | Y541A000000 | Crankcase |
| 98 | Y5470000000 | Connecting Rod Assy |
| 99A | Y542ZC00000 | Piston Assy |
| 99A-99 | Y5490000000 | Circlip of Piston Pin |
| 99A-100 | Y5420000000 | Piston Assy |
| 99A-101 | Y5480000000 | Piston Pin |
| 99A-102 | Y5450000000 | Scraper Ring |
| 99A-103 | Y5460000000 | Bushing Ring |
| 99A-104 | Y5440000000 | Piston Ring II |
| 99A-105 | Y5430000000 | Piston Ring I |
| 106 | Y34A0000000 | Gasket of Gear |
| 107 | Y3350000000 | Gasket of Crankcase |
| 108 | Y3331200000 | Refueling rod assembly |
| 109 | BD006B00000 | "o" Ring $\phi 20 \times \phi 2.3$ |
| 110 | Y3320000000 | Lubricating Pipe |
| 111 | Y2360000000 | Locating Pin Crankcase |
| 112 | Y3360000000 | Locating Pin Crankcase |
| 113 | BD004H00000 | "O" Ring $\phi 21 \times \phi 2.3$ |
| 114 | B1016W10012 | Draining Oil Bolt |
| 115 | B5021W00000 | Draining Oil Bolt Gasket |
| 116 | Y3310000000 | Crankcase Cover |
| 117 | BC008H00000 | Oil Seal |
| 118 | Y25B0000000 | Tappet |
| 119 | Y5510000000 | Camshaft |
| 120 | Y2650000000 | Gear Shaft Hold Plate |
| 121 | Y2640000000 | Sliding Sleeve |
| 122 | Y2610000000 | Gear Shaft Assy |
| 123 | Y3620000000 | Circlip of Gear shaft |
| 124 | B5049W00000 | Flat Washer |
| 125 | B3072W00000 | Screw |
| 126 | Y3WDKG00000 | Switch |
| 127 | B2031W00000 | Nut |
| 128 | Y3B9XY00000 | Wire |
| 129 | B2007W00000 | Nut |
| 130 | Y3B60000000 | Relay |
| 131 | B1053W05012 | Bolt |