

VeGA GT4452

2021

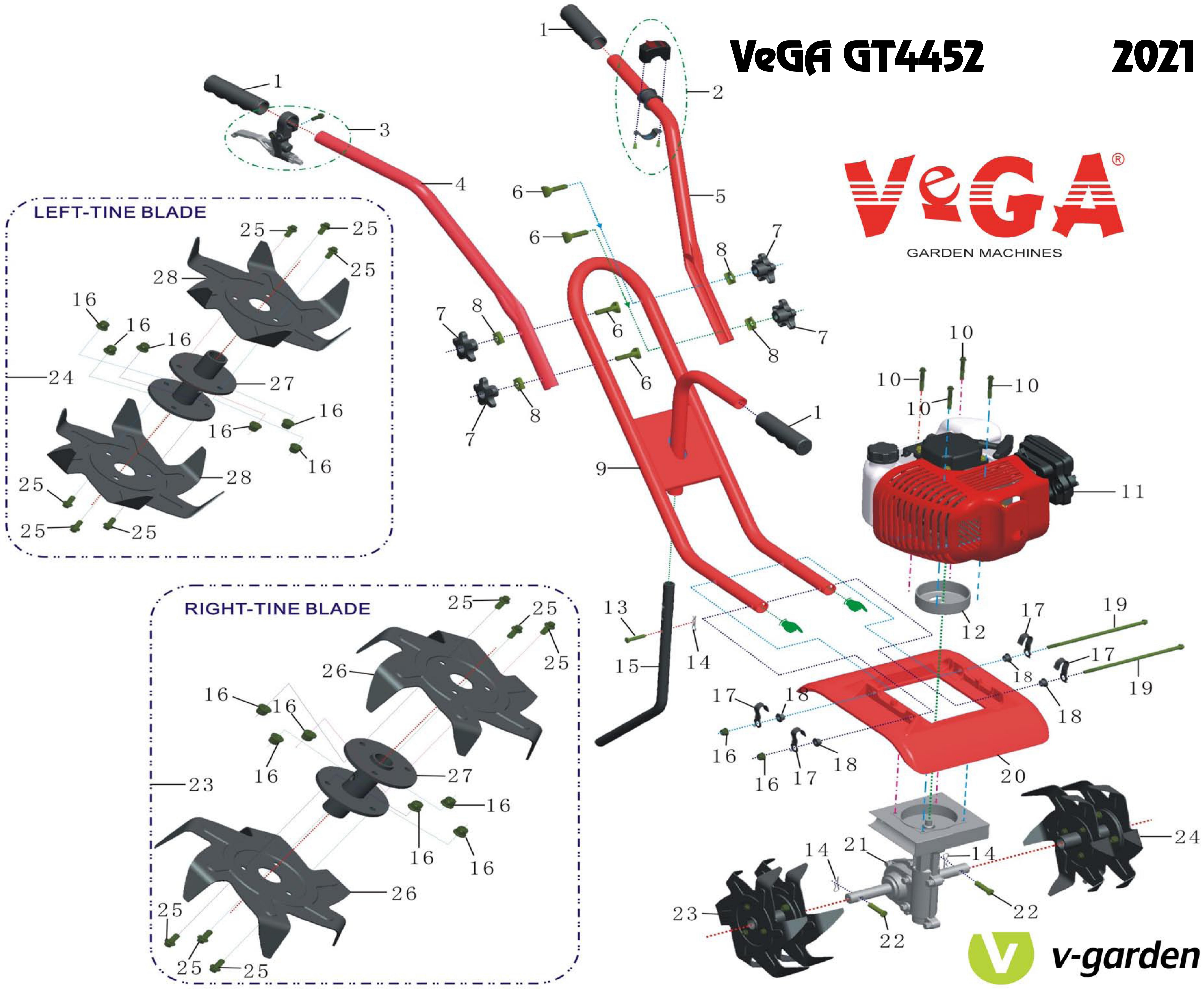

No.	ID Zboží	Název
1	50GT5244V01	grip
2	50GT5244V02	stop switch assy.
3	50GT5244V03	Trottle lever
4	50GT5244V04	handle, right upper
5	50GT5244V05	handle, left upper
6	50GT5244V06	bolt, knob,M8×50
7	50GT5244V07	knob, handlebar
8	50GT5244V08	washer, knob
9	50GT5244V09	Handle bracket
10	50GT5244V10	bolt, flanged M6×40
11	50GT5244V11	engine 1E44F-5A
12	50GT5244V12	Clutch drum
13	50GT5244V13	clevis pin $\Phi 6 \times 30$
14	50GT5244V14	hairpin clip $\Phi 2 \times 25$
15	50GT5244V15	Depth regulator
16	50GT5244V16	nut, flanged, locking M6
17	50GT5244V17	Cable bracket
18	50GT5244V18	spacer $\Phi 16 \times \Phi 11 \times 2 \times 8$
19	50GT5244V19	bolt, flanged M6×170
20	50GT5244V20	Mudguard
21	50GT5244V21	transmission
22	50GT5244V22	clevis pin $\Phi 8 \times 25$
23	50GT5244V23	tines, RH
24	50GT5244V24	tines, LH
25	50GT5244V25	bolt, flanged M6×12
26	50GT5244V26	blade, RH
27	50GT5244V27	blade holder(bracket)
28	50GT5244V28	blade, LH
29	50GT5244V29	throttle cable

Motor VeGA 52 cc - 2-takt

model VeGA GT4452 2021

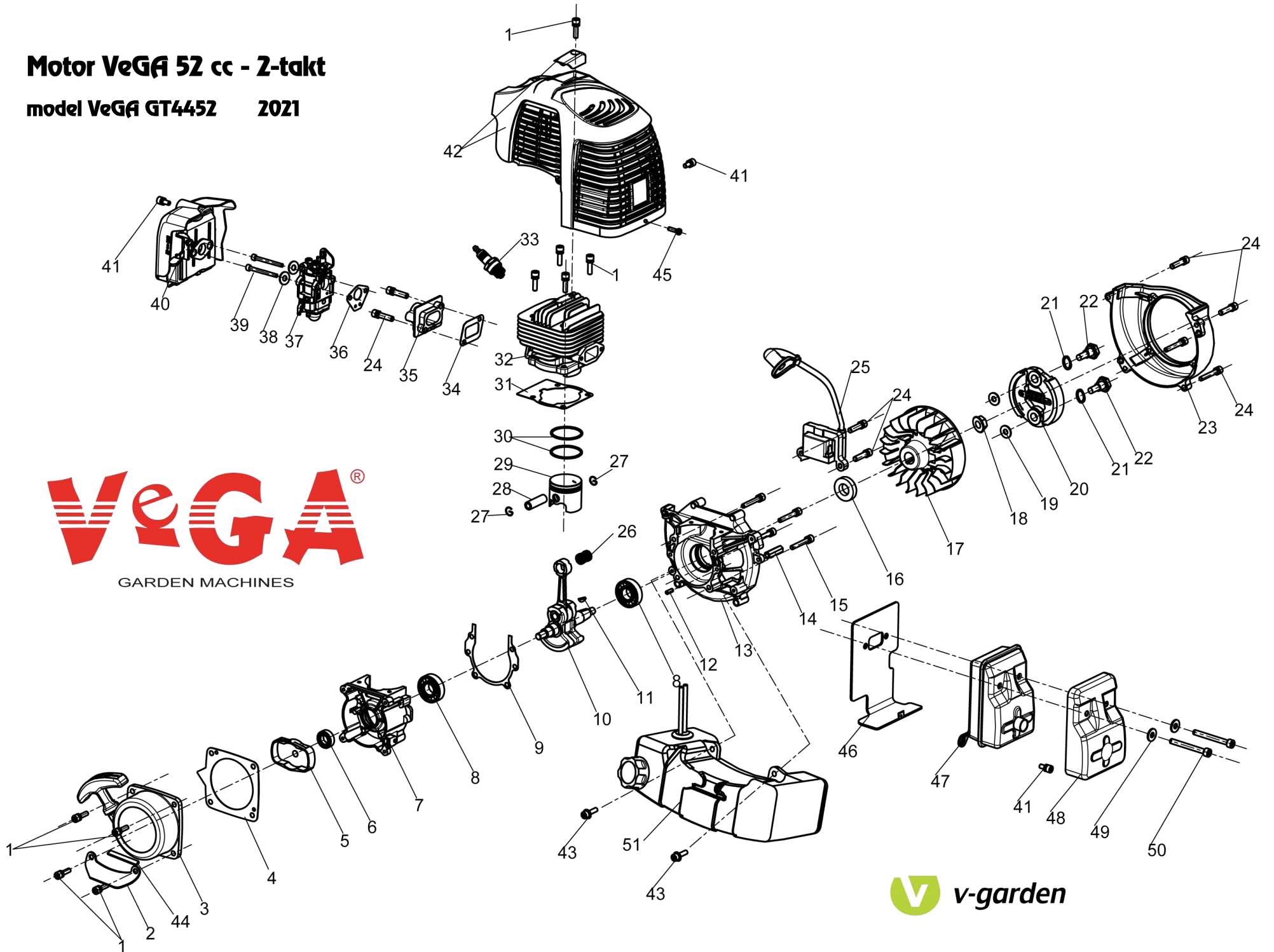

VeGA®

GARDEN MACHINES

No.	ID Zboží	Název
1	50BC525M10	Bolt M5x20
2	50GT5244M5150107601	305B/415B oil pot press plate
3	50GT5244M4030504601	415B easy starter
4	50GT5244M5150107401	415B,520B starter gasket
5	50GT5244M4010503501	415B dial double dialing claw/star
6	50BC525M54	Oil seal 12x22x7
7	50BC525M53	Right crankcase
8	50BC525M49	Bearing 6202
9	50GT5244M5860102301	415B,520B box pad
10	50BC525M51	Crankshaft
11	50BC525M50	Woodruff key
12	50BC525M45	Pin \varnothing 5x10
13	50BC525M48	Left crankcase
14	50GT5244M5231600301	External hexagonal stud/M5/Column 26MM
15	50BC525M47	Bolt M5x35
16	50BC525M46	Oil seal 10x30x7
17	50BC525M09	Flywheel
18	50BC525M08	Flange nut M8
19	50BC525M07	Washer
20	50BC525M06	Clutch
21	50BC525M05	Washer
22	50BC525M04	Screw, Clutch
23	50BC525M03	Side cover
24	50BC525M01	Bolt M5x25
25	50BC525M11	Ignition coil
26	50BC525M34	Needle bearing
27	50BC525M33	Snap ring. Piston pin
28	50BC525M32	Piston pin
29	50BC525M31	Piston
30	50BC525M30	Piston ring
31	50BC525M29	Gasket, cylinder
32	50BC525M28	Cylinder
33	50BC525M13	Spark plug
34	50BC525M35	Gasket, Inlet pipe
35	50BC525M36	Inlet pipe
36	50BC525M37	Gasket, Carburator
37	50BC525M38	Carburator
38	50GT5244M5260101601	flat washers, 5.5x12x1
39	50BC525M40	Bolt M5x55
40	50GT5244M5010248903	Empty filter assembly
41	50GT5244M5230504001	Hex combination screw M5x12
42	50GT5244M5010248609	cylinder cover
43	50GT5244M5230500501	Hex combination screw M5x25
44	50GT5244M5110107901	pad
45	50BC525M17	Bolt M4x12
46	50BC525M27	Gasket, Muffler
47	50BC525M25	Muffler
48	50BC525M23	Heat insulation, Muffler
49	50GT5244M5260107801	Flat gasket 6x12x16
50	50BC525M22	Bolt M6x55
51	50GT5244M4990108201	Oil pot